

Aesthetic Procedure Chair



Operator & Owner's Manual

gio pelle
skincare

Table of Contents

Unpacking Your Aesthetic Chair	3
Inspection Checklist	3
Aesthetic Chair Dimensions.....	4-5
Attaching Aesthetic Chair Parts & Accessories.....	6-13
Attaching Wheels.....	6
Attaching Gliders	7
Connecting the Power Cord	7
Attaching Hand Control & Foot Control	8
Adjusting Chair Backrest & Legrest	8
Attaching Headrests	9
Attaching Footrest.....	10
Attaching Armrests	10
Attaching Paper Holder	11
Attaching Armboard Kit	12
Attaching Rails and Stirrups.....	13
Operating Aesthetic Chair	14-19
Backrest Up / Down	14
Footrest Up / Down.....	15
Chair Up / Down.....	16
Seat Up / Down.....	17
Locking the Wheels.....	18
Adjusting Armrests / Armboard	18
Using the Paper Holder	19
Using the Multi-Use Power Outlets.....	19
Maintenance.....	20
Troubleshooting.....	21
Weights & Electrical Specifications	22
Notes.....	23
Warranty.....	24

Thank you for purchasing the Gio Pelle Aesthetic Procedure Chair. This precision designed piece of equipment, engineered with you in mind, will provide many years of trouble free operation. It will save time and increase your ability to service your client in ways you never believed possible.

Please read carefully and understand this owner's manual before proceeding. Be sure to thoroughly familiarize yourself with the operation of the equipment prior to using it.

We appreciate your business and believe the performance, value and reliability of our equipment will earn your trust.

Sincerely,

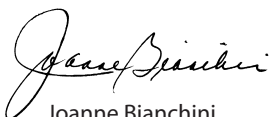

Joanne Bianchini
President Gio Pelle, Inc.

Gio Pelle, Inc. reserves the right to incorporate any modifications or improvements in machines and machine specifications which it considers necessary and does not assume any obligation to make these said changes in machines and equipment previously sold. The information in this document is subject to change without notice and does not represent a commitment on the part of Gio Pelle, Inc. Slight variations may occur during the manufacturing process, therefore, specifications including measurements, colors, options, and accessories are subject to change without notice. Please visit our website for the most up-to-date specifications. No part of this document may be reproduced or transmitted in any form or by any means, electronic or mechanical, including photocopying, for any purpose without the express written permission of Gio Pelle, Inc.

Unpacking Your Aesthetic Chair

*Your chair should look like the photo shown below when removed from the shipping box.
You will need to attach the parts shown in the "Inspection Checklist" to the chair.*

1. Carefully unpack your Aesthetic Chair. Pay special attention not to damage any parts or upholstery with box knives or other tools during the unpacking process.
2. Use the checklist below as you unpack each Aesthetic Chair part.

NOTE: If any of the parts shown below are missing or have been damaged during shipping please contact Gio Pelle, Inc. at 800-428-1610.



Inspection Checklist

Every Aesthetic Procedure Chair includes the parts shown below and were included in the purchase price.

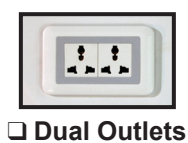
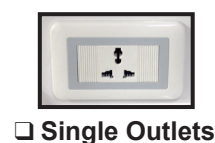

Your chair may include these parts which were purchased for an additional cost



Aesthetic Chair Specifications

Dimensions

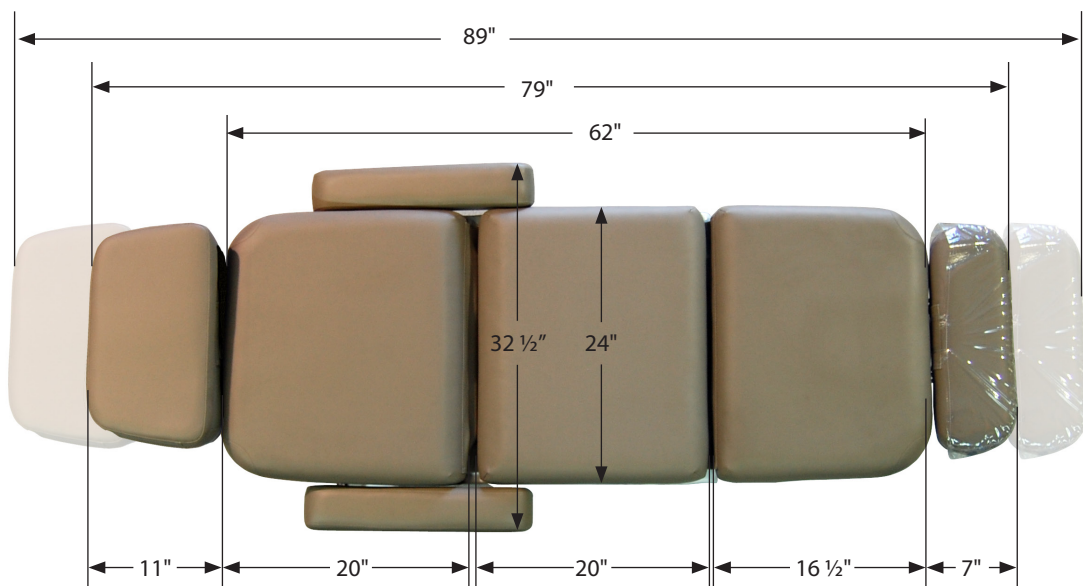

Note: Slight variations may occur during the manufacturing process, therefore, specifications including measurements, colors, options, and accessories are subject to change without notice. Please visit our website for the most up-to-date specifications.

Aesthetic Chair Specifications

Dimensions

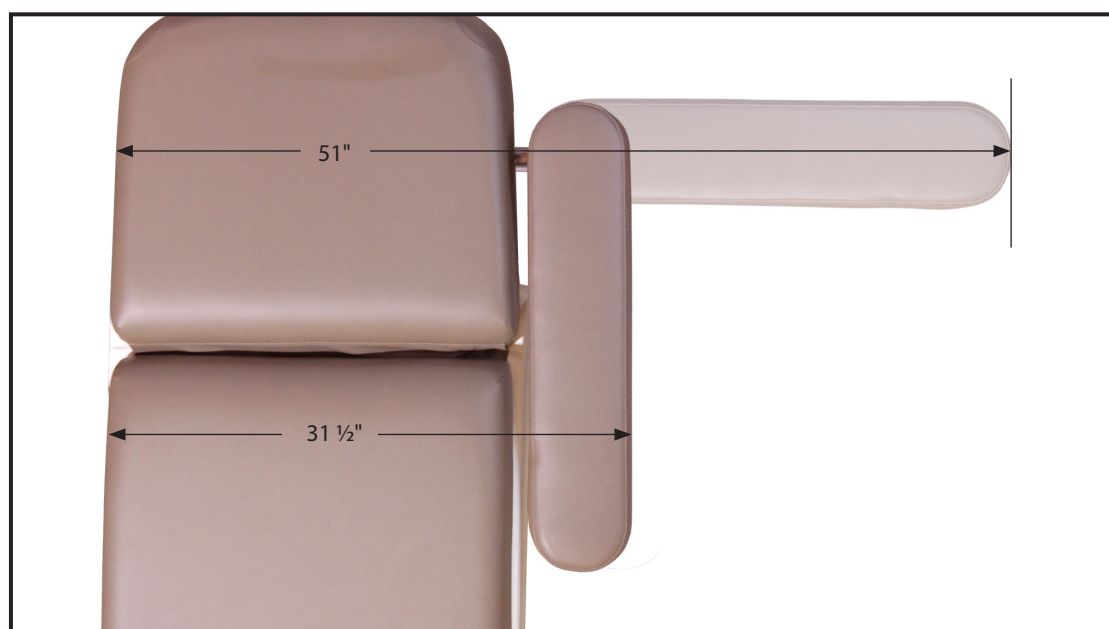

Attaching Aesthetic Chair Parts & Accessories

Part 1: Attaching Wheels

SKIP TO PART 2 IF YOU DID NOT PURCHASE WHEELS

PART 1/STEP 1: Elevate One End of Chair

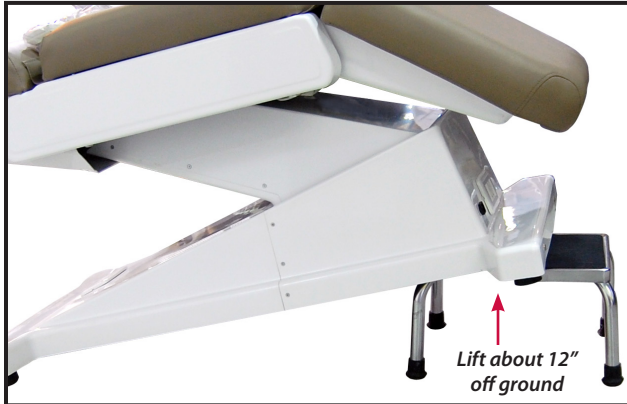

1. Elevate one end of the chair about 12 inches.
2. Chair needs to rest on something sturdy that will not move (like the step stool shown in photo).

PART 1/STEP 2: Remove Leveling Feet

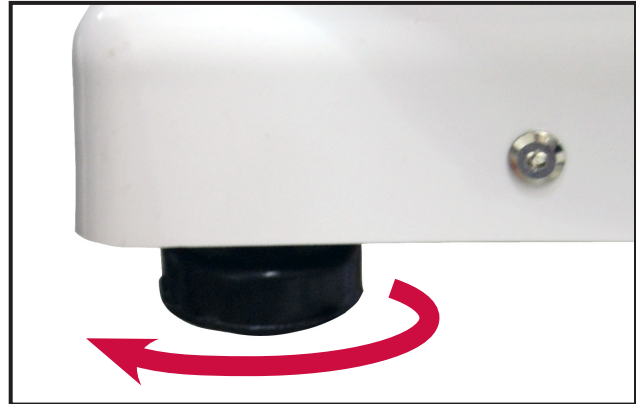

1. Remove the factory installed Leveling Feet by rotating them **COUNTER CLOCKWISE**.
2. Repeat for other leveling feet.

PART 1/STEP 3: Attach Wheels to Chair

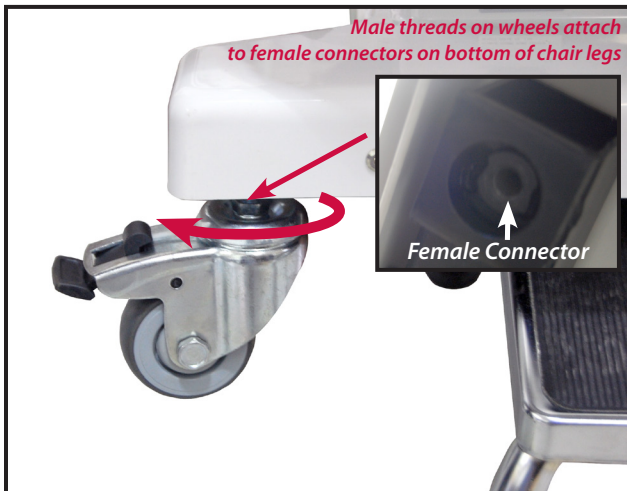

1. Insert male threads on top of the casters into the female connectors on the bottom of the chair legs.
2. **Hand tighten** wheel assembly by turning it **CLOCKWISE** until assembly no longer turns.

PART 1/STEP 4: Secure Wheel with Wrench

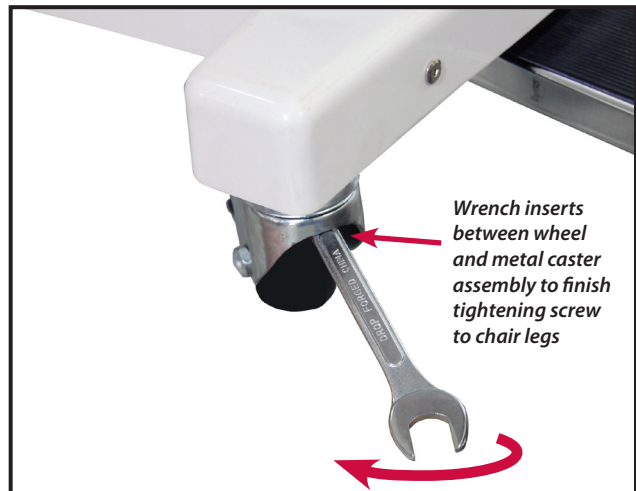

1. Use an 11/16" inch wrench to finish securing the wheel assembly to the chair legs.

CAUTION: Casters must be securely attached to chair **WITH WRENCH** to prevent personal injury and/or damage to chair

2. Lower chair end.

PART 1/STEP 5: To connect wheels to opposite side of chair repeat Steps 1 through 4.



Helpful Hint: Turn wheels parallel to frame of chair so they are not in the way during procedures.

Attaching Aesthetic Chair Parts & Accessories

Part 2: Attaching Gliders

SKIP TO PART 3 IF YOU DID NOT PURCHASE GLIDERS

PART 2/STEP 1: Elevate One End of Chair

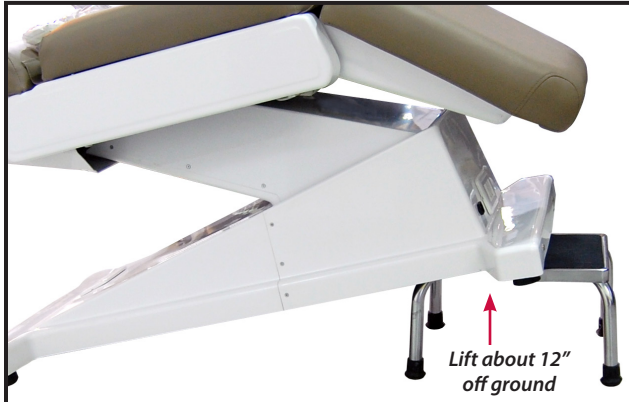

1. Elevate one end of the chair about 12 inches.
2. Chair needs to rest on something sturdy that will not move (like the step stool shown in photo).

PART 2/STEP 2: Remove Leveling Feet

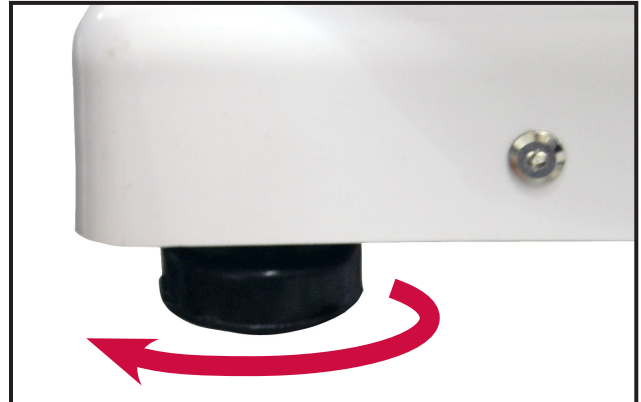

1. Remove the factory installed leveling feet by rotating them **COUNTER CLOCKWISE**.
2. Repeat for other leveling feet.

PART 2/STEP 3: Attach Gliders to Chair

1. Insert male threads of the glider into the female connectors on the bottom of the chair legs.
2. **Hand tighten** glider by turning it **COUNTERCLOCKWISE** until it no longer turns.
3. Lower chair end.

Step 4: To connect gliders to opposite side of chair repeat Steps 1 through 3.

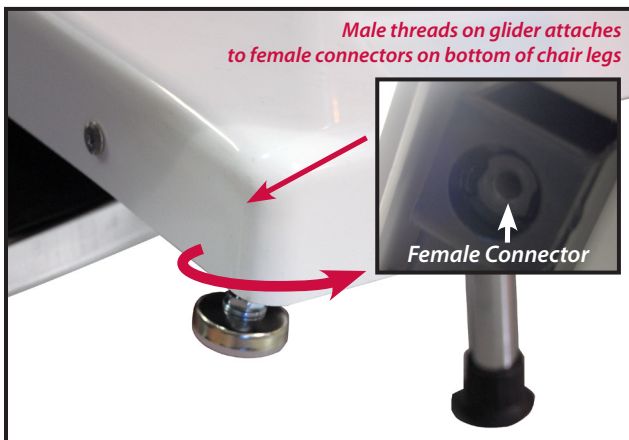

Part 3: Connecting Power Cord

PART 3/STEP 1: Plug Cord into Chair

1. Plug power cord into connector located on the base of the chair.

PART 3/STEP 2: Plug Cord into Wall

2. Plug the three prong end of the power cord into a properly grounded wall outlet supply 110vac (or 220vac depending on model).

WARNING:

Failure to plug power cord into a properly grounded electrical outlet with the correct voltage can result in damage to the chair.

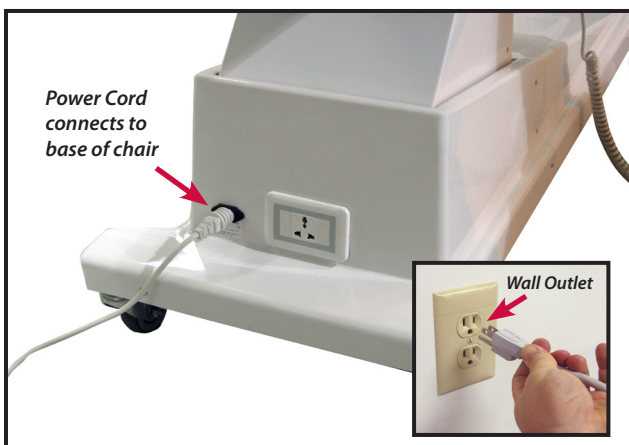

Attaching Aesthetic Chair Parts & Accessories

Part 4: Attaching Hand Control and Foot Control

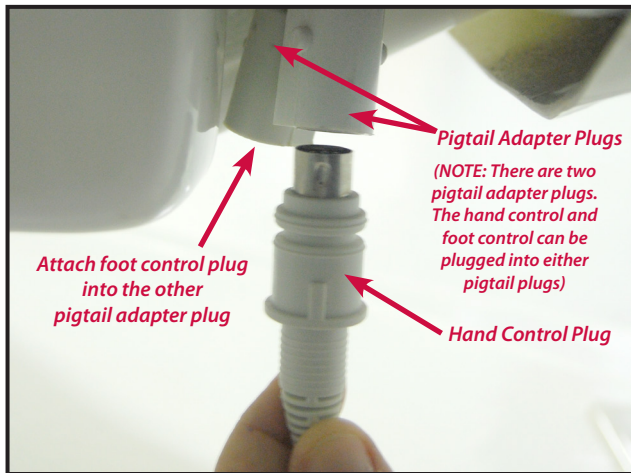

PART 4/STEP 1: Plug Hand Control into Chair

1. Insert hand control plug into one of the two pigtail adapter plugs located under the seat and behind the left side panel trim.

PART 4/STEP 2: Plug Foot Control into Chair

1. Insert foot control plug into the other pigtail adapter plug located under the seat and behind the left side panel trim.

NOTE: There are two pigtail adapter plugs. The hand control and foot control can be plugged into either pigtail plugs.

Part 5: Adjusting Chair Backrest & Legrest



PART 5/STEP 1: Adjust Backrest

1. Push the "BACKREST UP ARROW BUTTON" on the hand control until backrest is in the upright position.

PART 5/STEP 2: Adjust Legrest

2. Push the "LEGREST UP ARROW BUTTON" on the hand control until legrest is in the upright position.

Attaching Aesthetic Chair Parts & Accessories

Part 6: Attaching Headrests

PART 6/STEP 1: Attaching Headrests to Chair

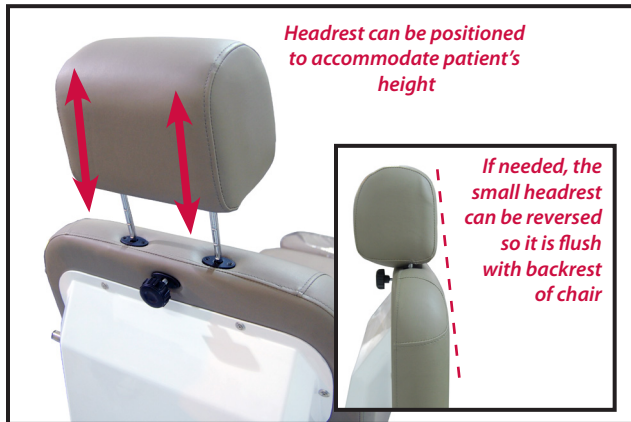

1. Carefully slide one of the headrests into the backrest of the Aesthetic Chair.
2. Headrests can be adjusted for patient's height by sliding it closer to or away from the backrest.

PART 6/STEP 2: Secure Headrest

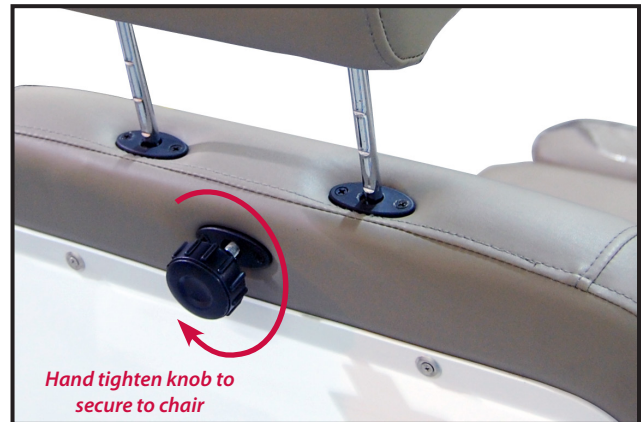

1. Hand tighten knob located on back of backrest to secure headrest to backrest after the headrest is positioned for patient comfort.

HELPFUL HINTS

Large Headrest Helpful Hint

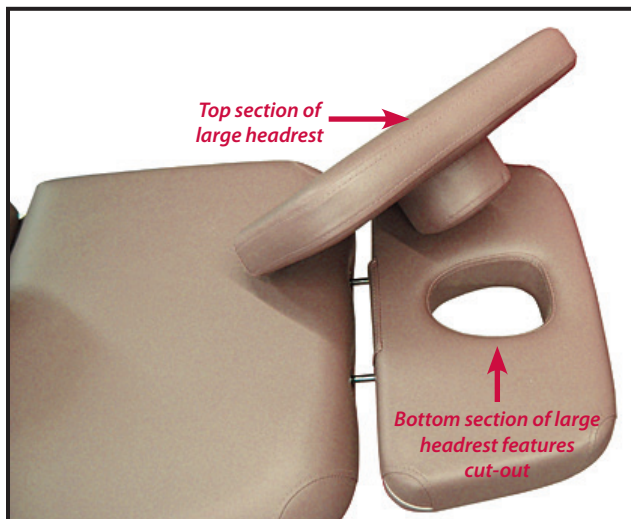

The large headrest cushion contains a cut-out for prone position procedures. Lift the top part of the cushion away from the bottom part of the cushion to reveal the face cut-out.

Articulating Headrest Helpful Hint

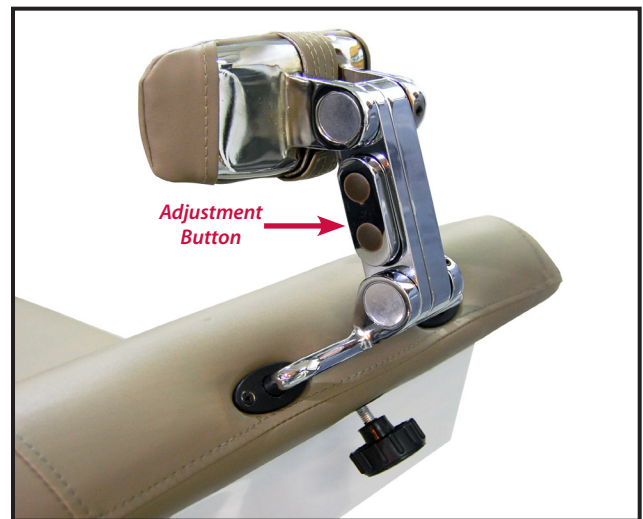

Articulating Headrest adjustment button **MUST** be on the **LEFTSIDE** of the chair when attaching it to the backrest. If attached to chair with adjustment button on the right side, headrest will not work properly.

Attaching Aesthetic Chair Parts & Accessories

Part 7: Attaching Footrest

PART 7/STEP 1: Attaching Footrest



1. Carefully slide the footrest into the legrest of the Aesthetic Chair.
2. Footrest can be adjusted for patient's height by sliding it closer to or away from the legrest.

PART 7/STEP 2: Secure Footrest



1. Hand tighten knob located on bottom of legrest to secure footrest to legrest after the footrest is positioned for patient comfort.

Part 8: Attaching Armrests

PART 8/STEP 1: Remove Thumb Screw



1. Remove thumbscrew from armrest post by turning it COUNTER CLOCKWISE.

PART 8/STEP 2: Attach Armrest to Chair

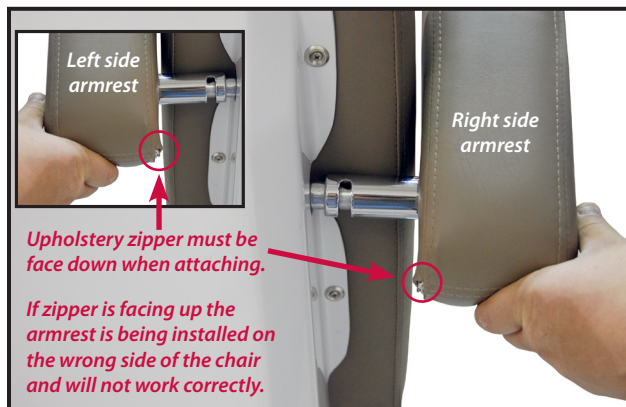

1. Slide armrest onto post.

PART 7/STEP 3: Secure Armrest to Chair

1. Hand tighten thumbscrew back onto chair post by turning it CLOCKWISE to secure armrest to chair.

PART 7/STEP 4: To connect armrest to opposite side of chair repeat Steps 1 through 3.

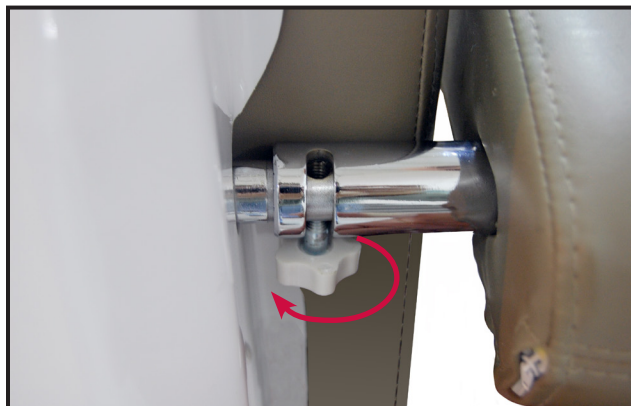

Attaching Aesthetic Chair Parts & Accessories

Part 9: Attaching Paper Holder

PART 9/STEP 1: Remove Backrest Screws

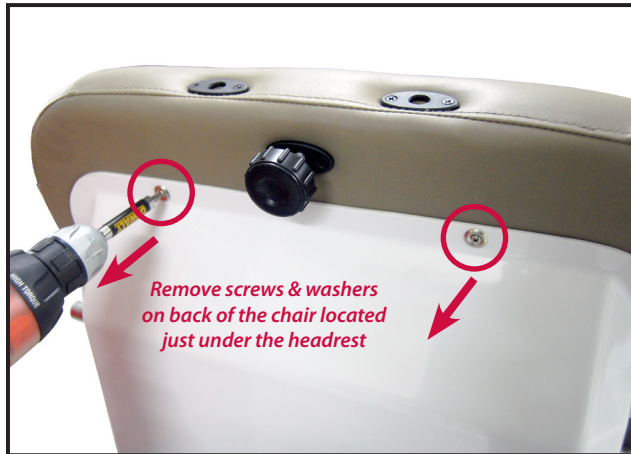

1. Use a Phillips screwdriver to remove the screws and washers located at the top of the backrest just under the headrest.

NOTE: Do not lose the screws and washers. You will need them to when attaching the paper holder.

PART 9/STEP 2: Attaching Bottom Brackets

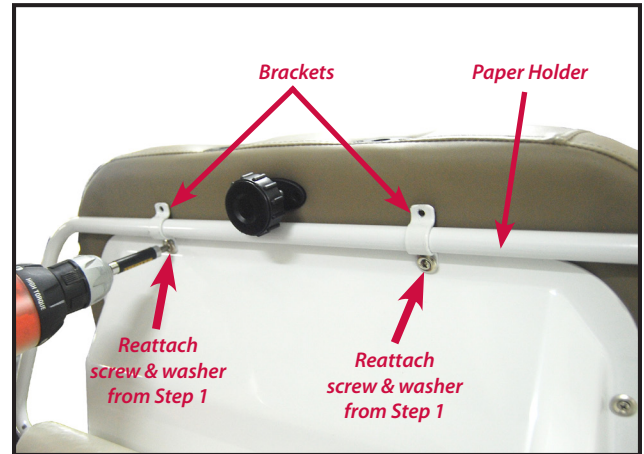

1. Using the two screws and washers from Step 1, attach the brackets and paper holder to the chair back.

NOTE: Make sure to attach the two screws and washers back into the holes that they were removed from.

PART 9/STEP 3: Create New Pilot Holes



NOTE: You will need to create pilot holes for the top screws to fit into.

1. Place one of the screws and a washer (included with bracket) into one of the top bracket holes.
2. Using a power screwdriver, slowly secure the screw into the chair back upholstery. You may need to apply a small amount of pressure as the screw is creating the new hole. **DO NOT OVERTIGHTEN.**
3. Repeat the above two steps to create a pilot hole and secure the top of the other bracket to the chair.

NOTE: If a power screwdriver is not available you may create a pilot hole using a power drill and the appropriate drill bit.

Helpful Hint

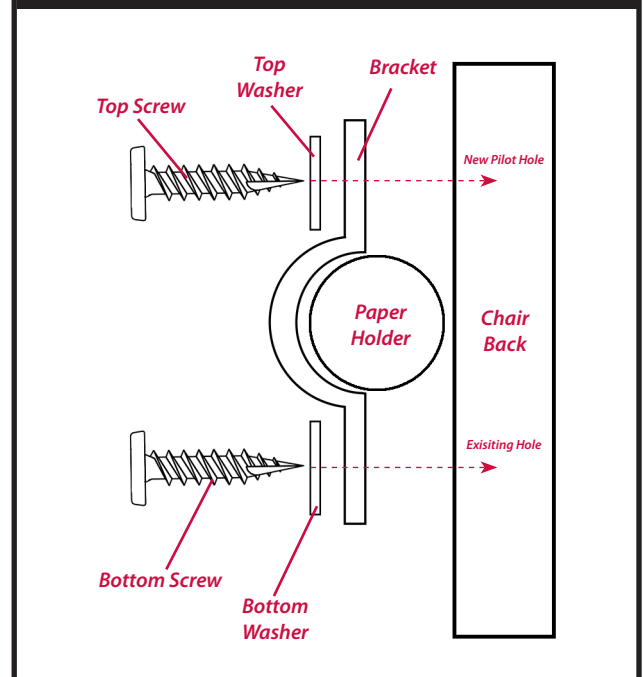

Attaching Aesthetic Chair Parts & Accessories

Part 10: Attaching Armboard Kit

PART 10/STEP 1: Remove Thumb Screw



1. Remove thumbscrew from armrest post by turning it **COUNTER CLOCKWISE**.

PART 10/STEP 2: Attach Armboard Post

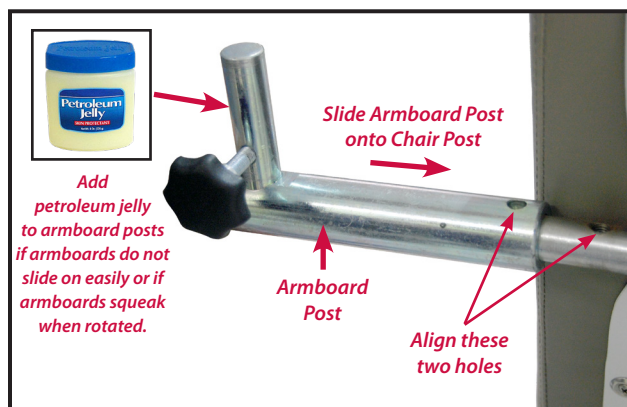

1. Slide armboard post onto chair post.
2. Align hole on armboard post with hole on chair post.

PART 10/STEP 3: Secure Armboard Post

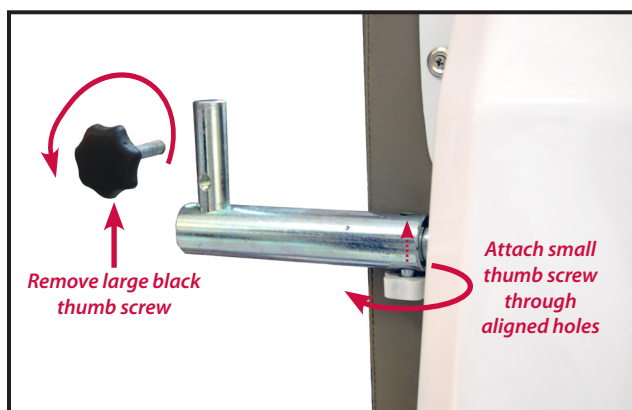

1. Insert small thumbscrew through aligned holes of the armboard post and the chair post.
2. Hand tighten small thumbscrew by turning it **CLOCKWISE**.
3. Remove large black thumb screw by turning it **COUNTER CLOCKWISE**.

PART 10/STEP 4: Secure Armboard to Post

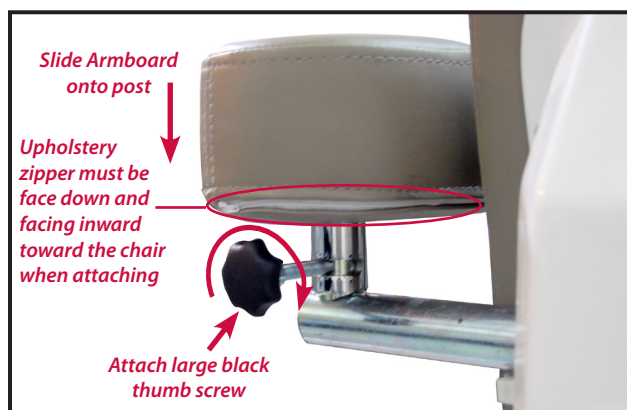

1. Slide armboard onto armboard post.
2. Hand tighten large thumbscrew onto armboard post by turning it **CLOCKWISE** to secure armboard to post.
3. Make sure that the upholstery zipper for the armboard is facing down and inward toward the chair when attaching. If the zipper is facing away from the chair, it is being attached incorrectly and will not work properly.

PART 10/STEP 5: To connect armboard to opposite side of chair repeat Steps 1 through 4.

Attaching Aesthetic Chair Parts & Accessories

Part 11: Attaching Rails & Stirrups

PART 11/STEP 1: Remove Plastic Caps



1. Remove the two round plastic caps on the trim of the chair located under the chair seat.

PART 11/STEP 3: Rail/Stirrup Brackets

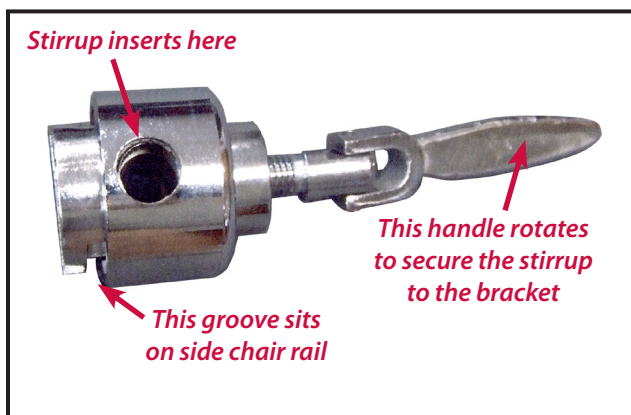

1. Locate the brackets that attach to the side rails and supports the stirrups.

PART 11/STEP 5: Set Screw



1. Thumb tighten set screw on both ends of siderail.

PART 11/STEP 2: Attach Side Rail

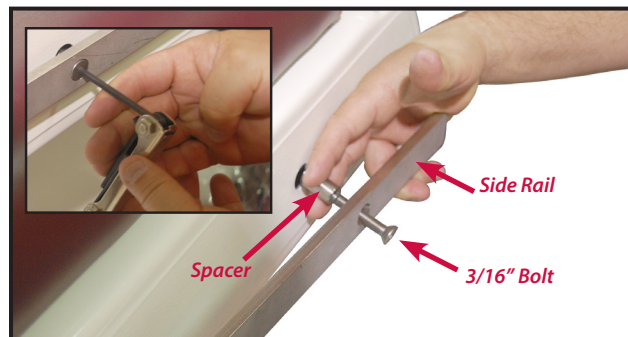

1. Insert 3/16" bolt through hole on side rail (tapered end out).
2. Slide spacer onto bolt.
3. Tighten bolt to chair using a 3/16" Allen wrench.

PART 11/STEP 4: Attach Stirrups

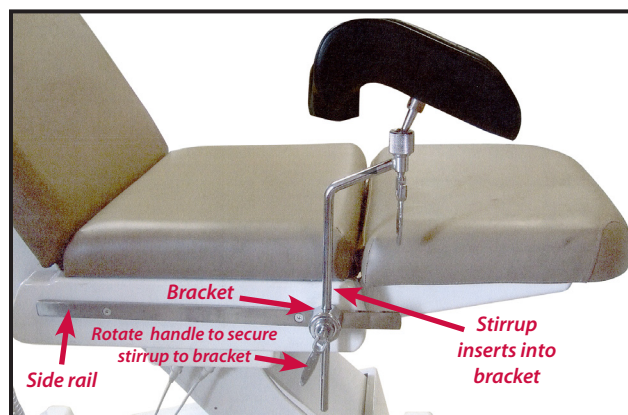

1. Slide groove of bracket over side rail.
2. Insert stirrup into bracket.
3. Rotate handle on bracket to secure it to siderail.

PART 11/STEP 6: To connect siderails and stirrups to opposite side repeat Steps 1 through 5.

Helpful Hint

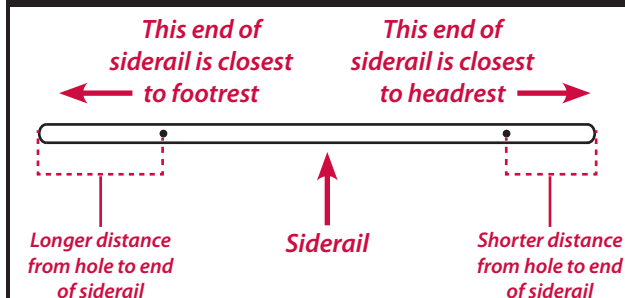

Operating Aesthetic Chair

Backrest Up / Down

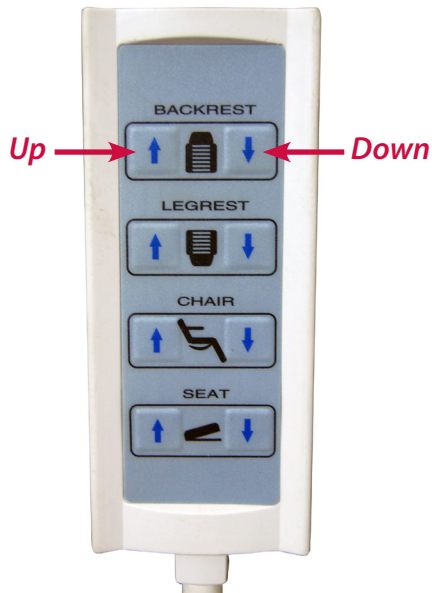

Hand Control



Foot Control



To Move Backrest Up

Press and hold the **BACKREST UP ARROW** button on the Hand Control/Foot Control.

To Move Backrest Down

Press and hold the **BACKREST DOWN ARROW** button on the Hand Control/Foot Control.

Operating Aesthetic Chair

Legrest Up / Down

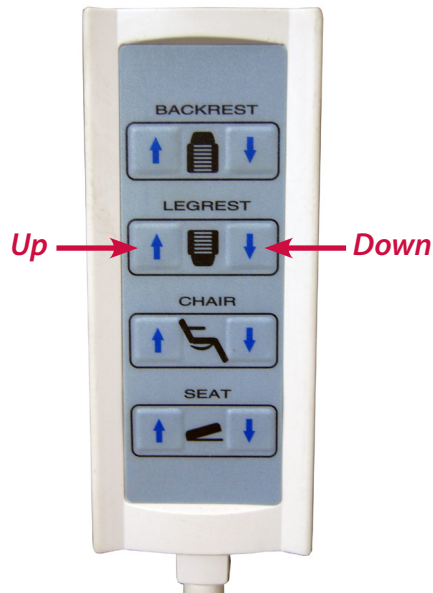

Hand Control

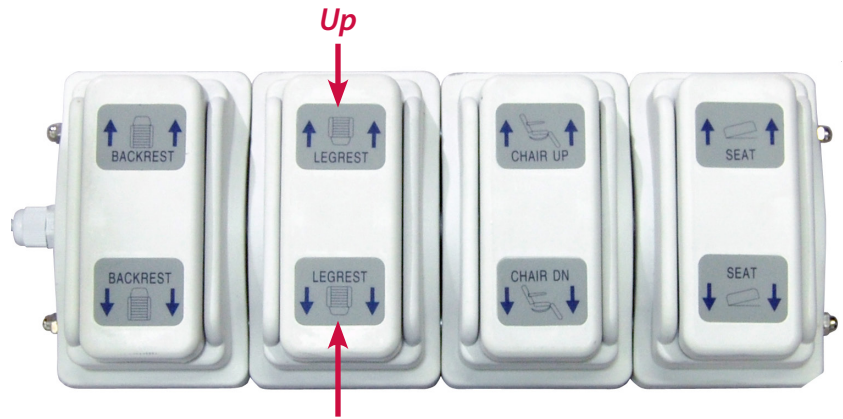

Foot Control

To Move Legrest Up

Press and hold the **LEGREST UP ARROW** button on the Hand Control/Foot Control.

To Move Legrest Down

Press and hold the **LEGREST DOWN ARROW** button on the Hand Control/Foot Control.



Operating Aesthetic Chair

Chair Up / Down

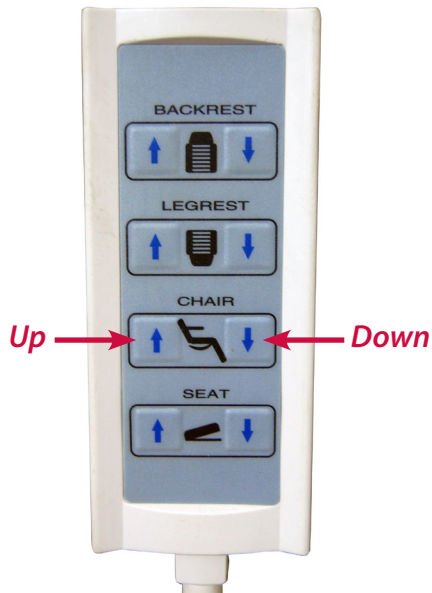

Hand Control

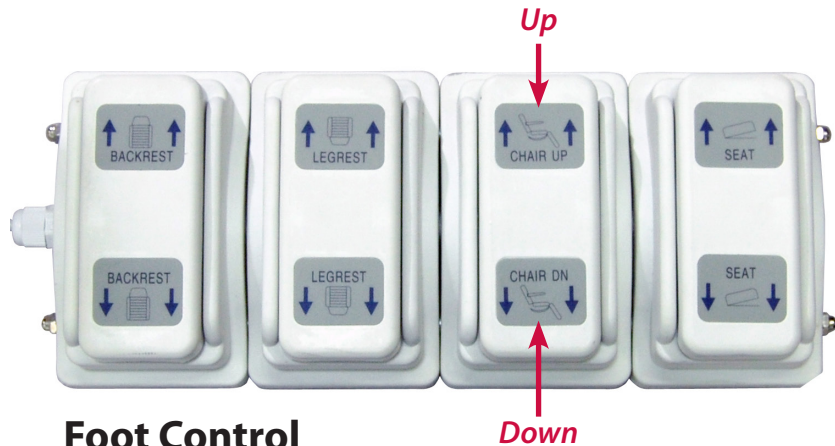

Foot Control



To Raise Chair Up

Press and hold the **CHAIR UP ARROW** button on the Hand Control/Foot Control.



To Lower Chair Down

Press and hold the **CHAIR DOWN ARROW** button on the Hand Control/Foot Control.

Operating Aesthetic Chair

Seat Up / Down

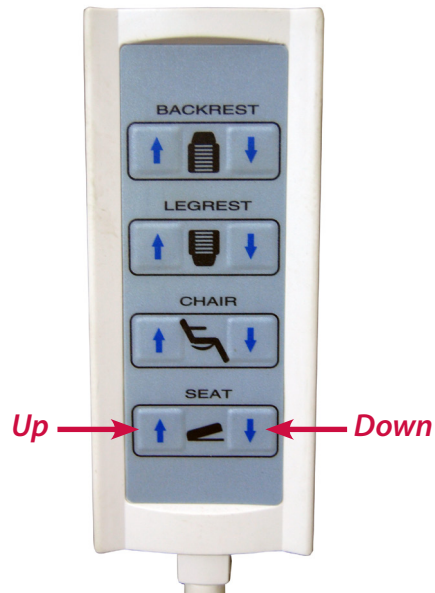

Hand Control



Foot Control

To Move Seat Up

Press and hold the **SEAT UP ARROW** button on the Hand Control/Foot Control.

To Move Seat Down

Press and hold the **SEAT DOWN ARROW** button on the Hand Control/Foot Control.

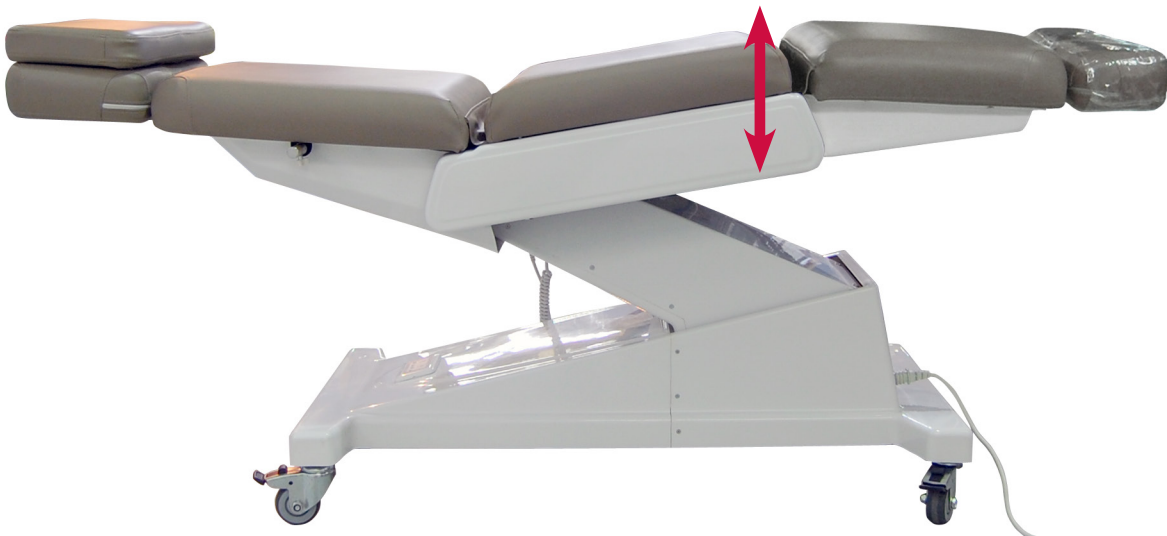

Operating Aesthetic Chair

Locking the Wheels



Locking Wheels

Push the caster lock **DOWN** to lock each wheel.

CAUTION

It is recommended to lock all four caster wheels prior to procedures to ensure patient and staff safety.

UnLocking Wheels

Pull the caster lock **UP** to unlock each wheel.

WARNING

Caster wheels must be unlocked before moving the chair. Moving the chair with the casters locked can damage the wheels and/or chair and void the warranty.

Adjusting Armrests / Armboard

Adjusting Armrests



Armrests can be rotated 180° from the front of the chair to the back of the chair.

NOTE: Armrests will not lock in an elevated position.

Adjusting Armboard

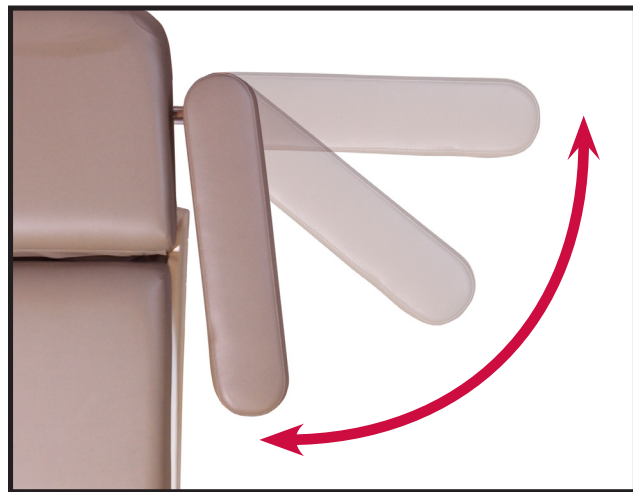

Armboard can be rotated perpendicular to chair.

Operating Aesthetic Chair

Using the Paper Roll

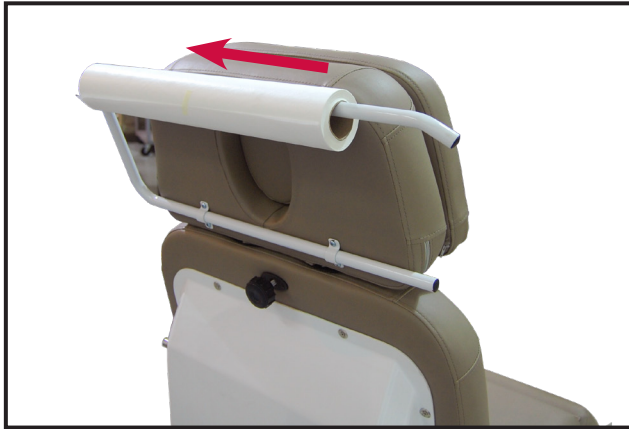

Attaching Paper Roll

Slide paper roll onto paper roll holder arm.

Using Paper Roll

Pull the paper over the headrest and secure the end of it between the legrest and foot rest.



Using Multi-Use Power Outlets

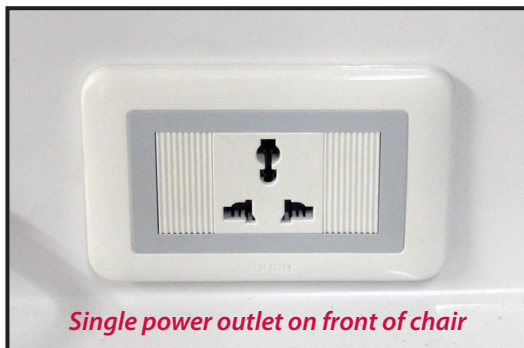

Single power outlet on front of chair

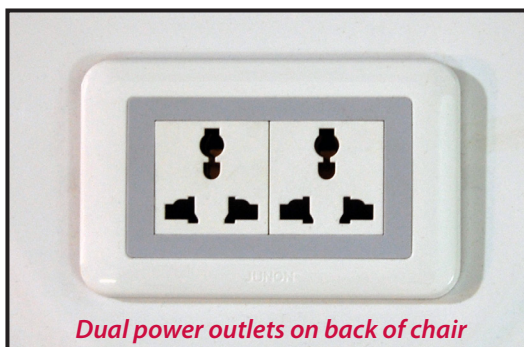

Dual power outlets on back of chair

Inserting Electrical Plugs

The Aesthetic Procedure Chair comes with Multi-Use Power Outlets (one outlet on the front of the chair, two outlets on the back of the chair).

These power outlets allow you to conveniently plug equipment directly into the chair.

The Multi-Use Power Outlets accept a large variety of power cords including the standard 3-prong power cords.

NOTE: All chairs are wired for 110V UNLESS specified.

Maintenance

Cleaning Aesthetic Chair Surfaces

Cleaning Upholstery

Chair upholstery is stain resistant to most medical-type stains, however care should be taken to immediately remove any fluids spilled on the upholstery.

Spot Cleaning Upholstery.....Use mild soap and water

Difficult Stains on UpholsteryUse mild solvent

Disinfecting UpholsteryUse 20:1 diluted bleach solution (20 water: 1 bleach)

MadaCide Disinfectant and Steri-Fab may also be used

WARNING: Spot test any solvents or disinfectants in a small, inconspicuous place on your chair upholstery prior to applying to avoid damage to upholstery.

Cleaning Painted/Plastic/Metal Surfaces

Wipe painted, plastic and metal surfaces with a clean, soft cloth, and mild cleaners.

WARNING: Never submerge electrical parts including hand and foot controls into liquid. Doing so could result in personal injury as well as damage the submerged parts thereby voiding your warranty.

Inspect for Damage

Periodically inspect the following areas of your chair for damage:

- Power Cord should be free of cuts or other visible damage.
- All fasteners should be present and tightened securely.
- All mechanical functions should operate properly.

WARNING: Never operate the chair with a damaged power cord or with missing/damaged parts.

Calling for Service & Replacement Parts

We take pride in designing our equipment as reliable as possible. Occasionally though a problem does arise. Please make an attempt to follow the section on troubleshooting before calling. When contacting us, please have the equipment model number and serial number available.

Our office hours are 8am-6pm EST/EDT, Monday through Thursday and 8am-5pm EST/EDT on Friday.

If the part is covered (see terms of the warranty agreement) then prior to sending the part back, contact us for a return authorization number. Under the terms of the warranty, you must return the broken part to our factory ***prepaid***, then we will supply back to you a fully warranted replacement part at no additional cost.

Contact Information

Gio Pelle, Inc.

Local Phone: (317) 545-6196

Toll-Free: 800-428-1610

Fax: (317) 543-3289

w www.giopelle.com

Troubleshooting

If you have questions concerning any aspect of the installation or operation of the Aesthetic Procedure Chair please consult the troubleshooting steps below. If you can't find the answer in this manual, then call us.

If the problem you are encountering cannot be resolved after referring the troubleshooting steps below, please contact Gio Pelle, Inc. at 1-800-428-1610.

Problem	Possible Cause and Solution
No power to chair	<ul style="list-style-type: none"> • Make sure the chair cord is plugged into chair and plugged into a powered outlet with the correct voltage (page 7).
Chair cannot be positioned	<ul style="list-style-type: none"> • Make sure the chair is plugged into a power outlet with the correct voltage (pg 7). • Make sure the hand control and foot control are correctly connected to the chair.
Chair does not sit level	<ul style="list-style-type: none"> • Make sure chair sitting on a level floor • Adjust leveling feet or gliders until chair is level and does not wobble (page 6 & 7)
Wheels are loose/wooble	<ul style="list-style-type: none"> • Tighten wheels with 11/16" wrench (page 6)
Footrest slides out after inserted into chair	<ul style="list-style-type: none"> • Tighten knob located on bottom of legrest to secure footrest to chair (page 10)
Armrests will not rotate properly	<ul style="list-style-type: none"> • Armrest might have been installed on the wrong side. (page 10).
Stirrups wobble	<ul style="list-style-type: none"> • Tighten side rails that secure stirrups to chair (page 13). • Rotate handle on bracket to secure stirrups to bracket (page 13).
Articulating Headrest doesn't adjust properly	<ul style="list-style-type: none"> • Headrest might have been installed improperly (page 9).

Weights & Electrical Specifications

Patient Weight (Maximum).....450lbs.

Shipping Weight of Chair (with accessories).....300lbs.

Power Cord 10 1/2 ft.

Electrical Requirements 110V or 220v

Notes

Aesthetic Procedure Chair Serial Number: _____

Aesthetic Procedure Chair Warranty

2 Year Limited Warranty

Gio Pelle, Inc. warrants, only to the **original purchaser**, that the Aesthetic Procedure Chair and all **original** equipment accessories, are free of manufacturing and mechanical defects to the best of its knowledge, will function and perform as described elsewhere herein, and is fit for the purpose for which it is intended.

Gio Pelle will limit to and warrant for **2 Year, to the original purchaser only**, as long as it is determined that any failure was not caused by any type of misuse, abuse, accidental damage, tampering, any modifications or lack of required maintenance and cleaning as set forth in this manual. Gio Pelle, Inc. further warrants that, if required, all parts, accessories, and attachments shall be repaired or replaced (at the sole discretion of Gio Pelle, Inc.) at no cost to the original purchaser for a **limited period** of time. Call Gio Pelle, Inc. at 1-800-428-1610 for details.

To obtain service under this warranty, the original purchaser must obtain prior approval and a Return Goods Authorization Number (RGA Number). All equipment returned for repair or replacement must be shipped **pre-paid** to Gio Pelle, Inc.

This warranty may be declared **null and void** upon Gio Pelle Inc.'s sole discretion and determination of equipment misuse, abuse, accidental damage, tampering, modification, lack of required cleaning and maintenance, use by untrained operators, or use with any unauthorized accessories or abrasive media.

In no event shall Gio Pelle, Inc. be liable for any incidental, special or consequential damages. No other warranties, guarantees, or claims, expressed or implied to provide any other or additional warranties or guarantees or to change or modify this one in any way either verbally or in writing.



7740 Records Street • Indianapolis, IN 46226
(317) 545-6196 • 800-428-1610 • Fax: (317) 543-3289
www.giopelle.com

LAPCMANUALVER03-05-25-23