

# Gio Pelle Mobile Magnification Light

## Assemble & Operating Instructions



### Step 1

Insert pole into 5 star caster base.



### Step 2

Turn pole and base upside down. Place weight onto bottom of the base. It is recommended that a second person hold the base and pole while the weight is being attached.



### Step 3

Insert bolt into weight bottom and into pole.



#### Step 4

Tighten bolt.

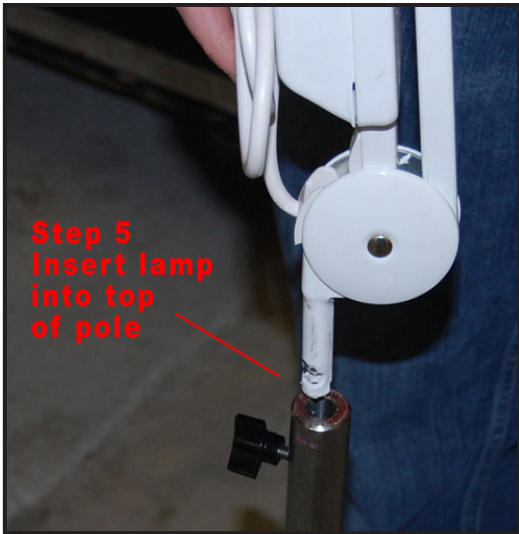

#### Step 5

Turn lamp right side up. Insert lamp into top of pole.

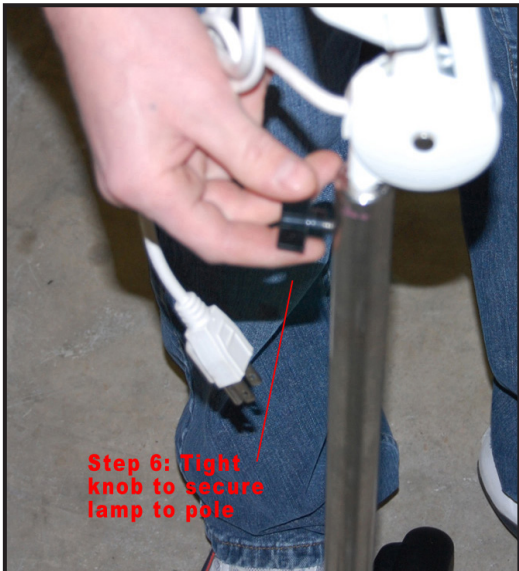

#### Step 6

Tighten knob to secure lamp to pole.

## Operating Instructions

1. Plug lamp into a standard three prong wall outlet.
2. Adjust lamp arm and head for personal preference. Lamp arm extends up to 33" and can be positioned at 90° without tipping with weight attached to bottom.
3. Press the **ON** button located on the lamp head.